



DAS HERZ DER FRISCHE

# WATER COOLED CONDENSERS

DP-271-1 EN



CXP SERIES



## Shell-and-tube condenser for normal water and sea water: CXP Series

### Applications

The CXP condenser for normal water is available for process cooling and air conditioning applications using HFC refrigerants at medium pressure (PS 30 barg) and high pressure (PS 45 barg). The CXP is also available for refrigeration applications using sea water (CXPM version).

### Technology

The design features high performance enhanced surface tubes which provide a better thermal efficiency improvement of +15% compared with previous CFC and CPS product lines. The CXP is optimized for HFC condensation and the new product line ensures a very compact design with reliable performance even at temperature approaches as low as 1,5 K.

### Design features

// The CXP condensers are available both as a standard catalogue product line and also as special customized designs to suit every need.

// CXP can be used with a wide range of water conditions and refrigerants including R404A, R407C, R134a and R410A.

// A modular front header (water boxes) offers the option of two or four passes. This feature is suitable for distributors who can keep a stock of only one item.

### Quotation guidelines

// Thermal sizing:  
SmarTube calculation software.

// Pricing: BITZER official heat exchanger and pressure vessel price list.

// Product information brochure is available.

### Basic features

// Condensing capacity:  
15-150 kW (50-500 kBtu/h)

// 2 and 4 water passes

// Shell diameters,  
ØD: 114, 141, 168 mm (4, 5, 6 in)

// Total length,  
L: 973-1906 mm (3,2-6,3 feet)

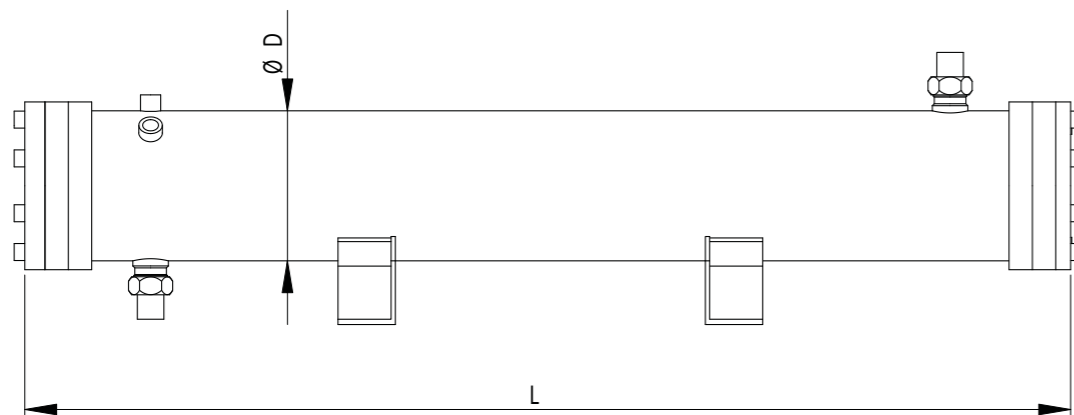

### Working principle condenser mode

// The refrigerant condenses on the outside of the tubes

// The water flows inside the tubes

### Standard components

	Normal water	Sea water
Tubes	Copper	CuNi 90-10
Tube sheet	Carbon steel	St. Steel 316L
Tube supports	Polymeric	Polymeric
Shell	Carbon steel	Carbon steel
Anodes		Carbon steel

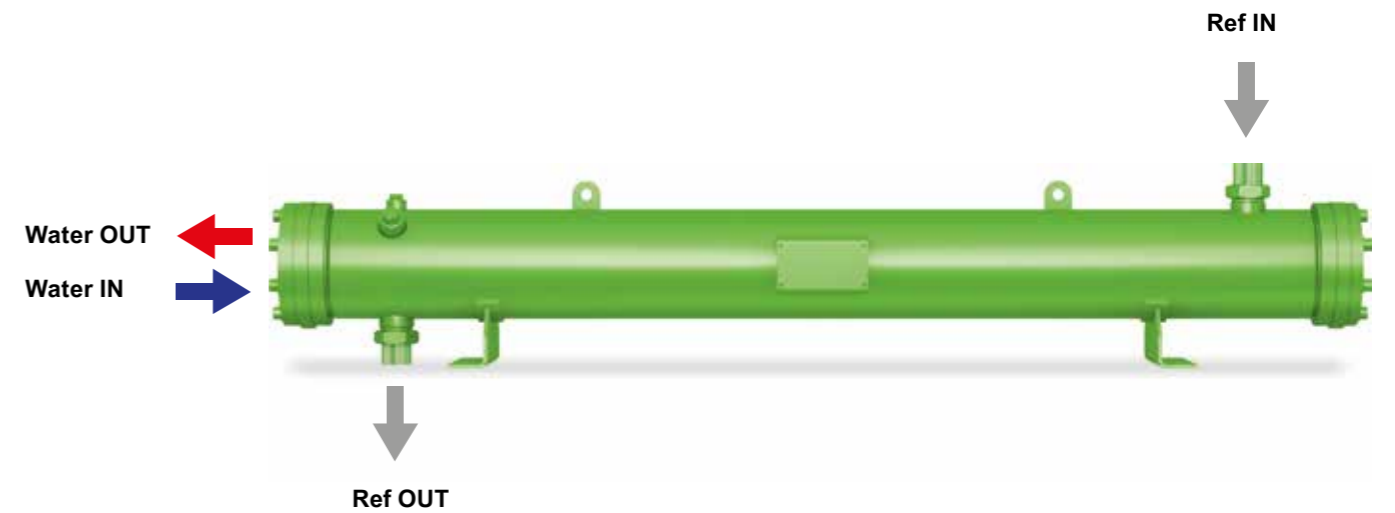

### Design data

#### PED (CE) approval

Version	Tube side			Shell side				
	PS (barg)	TS (°C)	TP (barg)	PS (barg)	TS (°C)	TP (barg)		
STD	10	-10	120	15,4	30	-10	120	43,6
HP	16	-10	120	24,6	45	-10	120	65,4

STD Standard // HP High Pressure - special on demand // PS Maximum allowable pressure //

TS Minimum/maximum allowable temperature // TP Test Pressure

// Other pressure vessel approvals and certifications available on request

Available on request

// Mounting feet

// Refrigerant operating level sight glass

ALWAYS NEARBY.  
BITZER WORLDWIDE.



**BITZER Kühlmaschinenbau GmbH**

Peter-Schaufler-Platz 1 // 71065 Sindelfingen // Germany

Tel +49 (0)70 31 932-0 // Fax +49 (0)70 31 932-147

bitzer@bitzer.de // [www.bitzer.de](http://www.bitzer.de)

Subject to change // [www.bitzer.de/empc](http://www.bitzer.de/empc) // 80192501 // 03.2026